

# BioCity Campus LEIPZIG

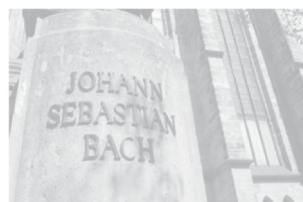

# Technology Hub Germany

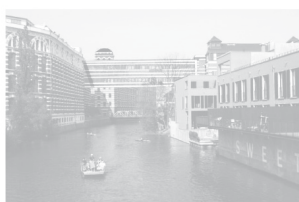

## International Leadership

Investors from all over the world appreciate Germany as one of the most attractive locations on a global scale. Germany is a leader in exports and also has the largest population in Europe.

Compared with other countries, Germany does particularly well in the realm of research & development, qualified workers and in regards to its top-notch infrastructure. Other positive factors include the central geographical location, logistics and a reliable legal framework.

Germany is synonymous for world-leading research and inventions. According to the European Patent Office, 24,000 patent applications have been registered from Germany in 2009 – much more than from any other European country.

## Biotechnology and Healthcare Sectors

Germany is highly attractive for the pharmaceutical industry and for medical- and biotechnologies.

With almost 600 companies in the biotechnology-sector Germany also has a clear leadership position in Europe. More than 40% of those companies develop health related products (red biotech). A total of 8% are working in the field of white biotech.

Germany has a highly diversified health-sector with high growth potential. As of today the health sector is one of the strongest markets in Germany with over 4.4 million employees. In comparison it is even larger than the world-class German car manufacturing industry.





# BioCity Campus Leipzig



BIO CITY LEIPZIG



Max Planck Institute

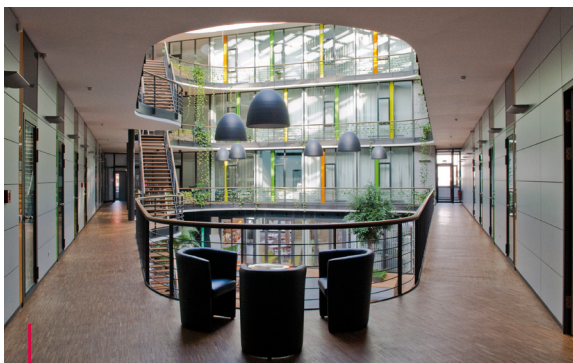

Fraunhofer Institute for Cell Therapy and Immunology

## A Priority for Biotechnology

Biotechnology is future. In the next few years biotechnology will have replaced IT as the most innovative part of the economy. For the City of Leipzig, Biotechnology has been supported for years with the highest level of priority. BioCity Campus is only one of many examples for this extraordinary commitment of the City.

## Synergies on Campus

Over the last ten years a number of research institutions and companies has settled on the former exhibition grounds in the central sector of Leipzig. The German National Library, the University Hospitals and the Veterinary Medicine Institute are all merely a stone throw away.

The BioCity Campus will start from here and aims to become an internationally recognized hub for research and businesses activities.

As of today the location already has a strong profile: University research institutions, the Fraunhofer-Institute for Cell Therapy and Immunology, the Max Planck Institute for Evolutionary Anthropology, the BIO CITY LEIPZIG with 22 companies and another Biotechnology Institute with 6 professorships form the corner stones of the BioCity Campus. The development within the BioCity complex has been so dynamic over the last few years that already construction of additional buildings is underway.

## A Clear Profile: Regenerative Medicine

We now aim to develop BioCity Campus further – with a clear focus on the dynamic fields of Biotechnology and Regenerative Medicines. A wide range of research institutions, start-up companies and established biotech-companies will form the core from which the BioCity Campus will become a prolific international technology hub.

Construction is well under way and we would be excited to welcome you as the next member of BioCity Campus.



# BioCity Campus Vision



1. German National Library
2. International School and Kindergarten
3. Center for Regenerative Therapies
4. European School for Regenerative Medicine
5. Max Planck Institute for Evolutionary Anthropology
6. BIO CITY LEIPZIG
7. Fraunhofer Institute for Cell Therapy and Immunology
8. Innovation Campus and Innovation Hall
9. Biotech Companies
10. BioCity Campus Extension Area



# Urban Center Leipzig



## Leipzig - In the heart of Europe

With almost 520,000 inhabitants, Leipzig is seen as cultural and economic center of Central Germany - a region with favourable transport links making it a hub within European business and industry. The new exhibition centre, an expanded airport and the establishment of well-known names in the world of industry such as Amazon, BMW, DHL and Porsche bear witness to Leipzig's economic dynamic.

## Education and Research – outstanding

Leipzig region harbours enormous R&D potential. The research landscape comprises the University of Leipzig, six other universities and colleges, three Max Planck institutes, and a host of non-university research centres.

Over 36,000 students make Leipzig a young and vibrant city.

Leipzig is a central part of the health economy, with excellent hospitals, internationally renowned doctors, top-level medical research institutions and high-performing companies whose medical and biotechnological products have won international respect.

Development is particularly dynamic in the life sciences. New arrivals over the past few years in this sphere include the IZI Fraunhofer Institute of Cell Therapy and Immunology, and the BBZ Centre for Biotechnology and Biomedicine at the University of Leipzig with six new chairs.

In Leipzig networking between companies and institutions has become the fundamental driving force for innovation.

## Leipzig - Feeling at home

Leipzig is a vivid city with a stunning cultural diversity. Lively arts scenes, a traditional pub culture and one of the most attractive city centres in Germany offer thousands of opportunities for having a good time.

An almost uninterrupted belt of buildings classified as fin-de-siècle and Jugendstil forms large parts of the inner city. The majority of these buildings have now been lovingly refurbished.

Those seeking housing in Leipzig really are spoilt for choice. The accommodation available are numerous and range widely. Monthly rents are about €5 per square metre depending on standards of quality.

Leipzig is a family-friendly city with an extensive, adequate supply of places in childcare facilities to make work compatible with family life. One example is Leipzig International School offering preschool, primary and secondary education.

With its green belt, a swathe of woodland, parks and floodplains, Leipzig is one of the greenest cities in Germany. When complete, a large new lake district on Leipzig's doorstep will allow the region – and even central Leipzig – to be explored from the waterside. This vast extent and variety of green spaces in Leipzig and its environs leaves enough room to relax and enjoy nature.

# BioCity Campus Leipzig

## Real Estate Options

The shaded grounds are available for companies requiring more than 2.500 m<sup>2</sup> of space. Additionally there are many options available upon request for lab space, offices and storage, starting from a single workplace to tailor-made buildings. Also we have options for almost all services you may require.

## Public funding

The framework for public funding for establishing businesses in Leipzig is extraordinarily good.

For the development of innovative products companies can receive research & development subsidies of up to 80% of the total cost. Furthermore public funding of up to 50% is available for investment costs of all kind and personnel expenses.



## Contact

Bernhard Faber  
BIO-NET LEIPZIG GmbH  
Deutscher Platz 5a  
D-04103 Leipzig

Telefon +49 (0) 341 212 07 - 0  
Telefax +49 (0) 341 212 07 - 11  
[www.biocity-campus.de](http://www.biocity-campus.de)  
[info@biocity-campus.de](mailto:info@biocity-campus.de)

ALTE  
MESSE LEIPZIG  
LEVG

Germany  
Land of Ideas



Selected Location 2010

NATIONALE  
STADT  
ENTWICKLUNGS  
POLITIK